

Stellar® Mechanics Service Cranes & Bodies

For questions or to place an order, contact HAWKEYE TRUCK EQUIPMENT at 515-289-1755 or 1-800-622-8223.



GUIDE TO FEATURES AND BENEFITS



Mechanics Trucks by Stellar Industries offer the most innovative features in the industry

- Complete turnkey packages available with a heavy-duty steel body and American Eagle air compressor and drawer systems
- Stellar service cranes feature hexagonal booms which makes them stronger, reduces boom flex and excessive side-to-side boom movement
- Stellar offers a wide range of lifting capacities up to 14,000 pounds
- Planetary winches provide line speed up to 60-feet per minute
- Up to 30-feet of hydraulic reach
- Quick release snatch block stow
- 400-degree power rotation on most models
- Standard Stellar® CDT™ and Stellar® CDTplus™ radio remote with optional E-Link control system
- On demand speed control
- Dual acting counter balance valves integrated into hydraulic cylinders
- Flip sheave with bar style ATB
- Stellar® CDTplus™ cranes offer -10 degrees to +80 degrees. This gives the operator both easy reach to snatch block stowing and the best ability to load items onto the load bed



Our People. Our Products.

STELLAR[®] MECHANICS SERVICE CRANES & BODIES

■ The Best Features in the Industry are Standard on Every Stellar[®] Model TMAX1[™], TMAX2[™] and TMAX3[™] Service Body...



- Rugged 12-gauge two-sided A-40 galvanneal steel body shell.

- The crane pedestal / compartment is constructed of steel material capable of handling the robust lifting capacity of Stellar cranes, including Stellar[®] CDTplus[™] equipped cranes. This provides the same storage space as other non-reinforced compartments.

- Enhanced boom rest, reduces crane boom movement when stowed and protects paint finish from damage.

- Exterior mounted light box provides maximum protection for the lights yet minimizes intrusion into the compartments.

- Bodies are finished with two-part polyurethane enamel.

- The rotating masterlock system soundly secures each door, and accepts your pad lock of choice to protect your valuable tool supply.

- 3-Point compression latches positively compress compartment weather strip for weather tightness, while allowing easy access.



- Door hinges are secured with hidden fasteners making for easy service, yet maximum security.

- Every Stellar mechanic service body features our torq-isolator crane support design and isolates the crane compartment from the rest of the side pack. Lifting stresses are transferred to the stabilizers and box-type subframe, not the compartment doors.

- Smooth steel workbench surface bumper, with recess for pintle hitch. Step bumper and grab handles are standard.

- A-coat and powder coated boom rest, stabilizers, lightbox and tailgate, provides better coverage and a harder finish.



Stainless steel billet style hinge has hidden fasteners and a rugged 5/16" stainless steel rod. All combined to stand up to years of heavy use.



Double-shell, 14-gauge outer panel, two-sided A-40 galvanneal steel hat section reinforced doors for durability and long life.



Double spring over center door closures on all vertical doors, keeps door in positive open or closed position.



250-lb capacity adjustable divider shelves made of spangled galvanized steel.

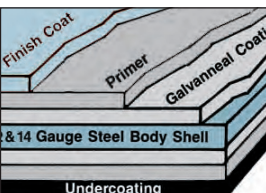

Complete undercoating, with minimum of 3 mils of petroleum base material, provides extra protection from corrosion and road debris.



Full width longbar storage compartment integrated into the rear workbench bumper. Removable vise pedestal is standard.



12-gauge double panel tailgate with hinged arm brackets to provide a stout working surface.



Encased in a durable nylon braided loom, the standard electrical wiring harness used by Stellar covers all functions, and features the use of weather-tight connectors.

■ Available Cranes

Model	Crane Rating	Boom Length*	Max Reach*	Lifting Capacities	Power Supply
3315	11,500 ft-lbs (1.59 ton-m)	7' (2.13 m)	15' (4.57 m)	3,200 lbs @ 3' (1,451 Kg @ .9 m) 750 lbs @ 15' (340 Kg @ 4.6 m)	PTO 2.0 gpm @ 2300 psi 12 volt power E/H (Optional)
4421	16,000 ft-lbs (2.23 ton-m)	11' (3.35m)	21' (6.40 m)	4,000 lbs @ 4' (1,814 kg @ 1.22 m) 760 lbs @ 21' (345 kg @ 6.40 m)	PTO 2.0 gpm @ 2600 psi 12 volt power E/H (Optional)
5521	29,500 ft-lbs (4.1 ton-m)	11' (3.35 m)	21' (6.40 m)	5,000 lbs @ 5' (2,265 kg @ 1.78 m) 1,400 lbs @ 21' (635 kg @ 6.40 m)	PTO 8 gpm @ 2500 psi
7621	44,840 ft-lbs* (6.20 ton-m)	11' (3.35 m)	21' (6.40 m)	7,500 lbs @ 5'10" (3,402 kg @ 1.78 m)* 2,135 lbs @ 21' (965 kg @ 6.40 m)*	PTO 8 gpm @ 3000 psi
7630	44,840 ft-lbs* (6.20 ton-m)	13' 4" (4.06 m)	30' (9.14 m)	7,500 lbs @ 5'10" (3,402 kg @ 1.78 m)* 1,490 lbs @ 30' (675 kg @ 9.14 m)*	PTO 8 gpm @ 3000 psi
9621	70,800 ft-lbs* (9.79 ton-m)	11' (3.35 m)	21' (6.40 m)	9,000 lbs @ 7'10" (4,082 kg @ 2.39 m)* 3,365 lbs @ 21' (1,525 kg @ 6.40 m)*	PTO 8 gpm @ 2500 psi
9630	70,800 ft-lbs* (9.79 ton-m)	13' 4" (4.06 m)	30' (9.14 m)	9,000 lbs @ 7'10" (4,082 kg @ 2.39 m)* 2,360 lbs @ 30' (1,070 kg @ 9.14 m)*	PTO 8 gpm @ 2500 psi
10621	70,800 ft-lbs* (9.79 ton-m)	11' (3.35 m)	21' (6.40 m)	10,000 lbs @ 7' (4,536 kg @ 2.13 m)* 3,365 lbs @ 21' (1,525 kg @ 6.40 m)*	PTO 8 gpm @ 3000 psi
10630	70,800 ft-lbs* (9.79 ton-m)	13' 4" (4.06 m)	30' (9.14 m)	10,000 lbs @ 7' (4,536 kg @ 2.13 m)* 2,360 lbs @ 30' (1,070 kg @ 9.14 m)*	PTO 8 gpm @ 3000 psi
12621	77,800 ft-lbs* (10.76 ton-m)	11' (3.35 m)	21' (6.40 m)	12,000 lbs @ 6.5' (5,443 kg @ 1.96 m)* 3,705 lbs @ 21' (1,680 kg @ 6.40 m)*	PTO 8 gpm @ 3000 psi
12630	77,800 ft-lbs* (10.76 ton-m)	13' 4" (4.06 m)	30' (9.14 m)	12,000 lbs @ 6.5' (5,443 kg @ 1.96 m)* 2,590 lbs @ 30' (1,175 kg @ 9.14 m)*	PTO 8 gpm @ 3000 psi
14528	82,600 ft-lbs* (11.42 ton-m)	13' (9.96 m)	28' (8.53 m)	14,000 lbs @ 5' (6,350 kg @ 1.52 m)* 2,950 lbs @ 28' (1,335 kg @ 8.54 m)*	PTO 12 gpm @ 3000 psi

* With Stellar® CDTplus™ boost mode. See technical specification brochure or manual for each specific model.

■ Stellar Exclusive Service Bodies



Model	GVWR	Crane Models	Cab to Axle	Length	Height	Comp. Depth	Floor Width
TMAX1™ Bodies	15,000-19,000	3315, 4421, 5521 7621, 7630	60"-84" (152-213 cm)	9'-11' (2.74-3.35 m)	44"-60" (112-152 cm)	22" (56 cm)	50" (127 cm)
TMAX2™ Bodies	19,000 and up	7621, 7630, 9621, 12621, 12630	84"-120" (213-305 cm)	11'-14' (3.35-4.27 m)	52"-60" (132-152 cm)	22" (56 cm)	50" (127 cm)
TMAX3™ Bodies	33,000 and up	14528	120" (304.8 cm)	14' (4.27 m)	52"-60" (132-152 cm)	22" (56 cm)	50"-52" (127-132 cm)
TMAX3T™ Bodies	46,000 and up	14528	147" (Cab to Trunnion) (373.38 cm)	17' (5.18 m)	52"-60" (132-152 cm)	22" (56 cm)	50"-52" (127-132 cm)

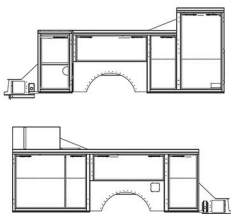

TMAX1™ Raised

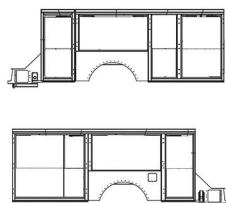

TMAX1™ All Raised

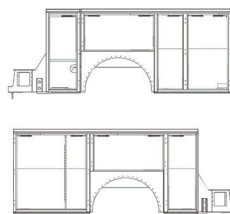

TMAX2-11™

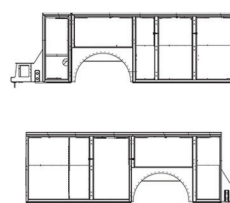

TMAX2-14™

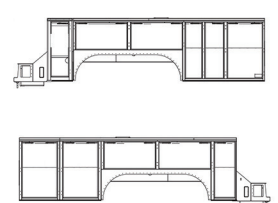

TMAX3T™